

Christmas candle holder

CROCHET PATTERN





Thank you for choosing my pattern!
Let's crochet these Christmas candle holders together,
that will delight you and your loved ones.
Enjoy crocheting!

NOTE:

- This pattern is intended for personal use. Distribution of the material or its part is prohibited!
- This description does not contain crochet lessons.
- When using the recommended materials and tools, the candle holder is 5 cm (2 inches) high, 5 cm (2 inches) in diameter.
- If you have any questions about crocheting in the process, you can contact me. I will be glad to help you.
- ! Please use the candle holder only with electric candles!



Required Materials:

1. Sport weight/4ply yarn YarnArt Jeans (55% cotton, 45% acrylic, 160m/50g)
 - color No.90 (red)
 - color No.01 (white)
 - color No.76 (blue)
 - color No.35 (yellow)
 - color No.52 (green)
 - color No.53 (black)
2. Hook size 2.5 mm
3. Long needle for sewing pieces
4. Hot glue gun (optional)
5. Beads for decorating
6. Snowflake sequins (optional)

Abbreviations:

- ch – chain
- MR – magic ring
- sl st – slip stitch
- sc – single crochet
- dc – double crochet
- tr – treble crochet
- hdc – half double crochet
- inc – increase
(2 sc in one stitch)
- dec – decrease (2 sc together)
- BLO – back loops only
- FLO – front loops only



Santa candle holder

Use red yarn (No. 90)

1. 8 sc in MR
2. inc*8 times (16)
3. (inc, 1 sc)*8 times (24)
4. (inc, 2 sc)*8 times (32)
5. (inc, 3 sc)*8 times (40)
6. BLO 40 sc
- 7-14. 40 sc (8 rounds)

Sl st to the next stitch

Cut the red yarn, weave in the end on the wrong side.

Attach the white yarn (No. 01) to the last stitch, where did sl st.

15. 40 sc
16. BLO (inc, 19 sc)*2 times (42)
17. BLO 42 sc

Change color to red.

18. BLO 42 sc
- 19-23. 42 sc (5 rounds)

Change color to black (No. 53).

- 24-26. 42 sc (3 rounds)

Cut the black yarn, weave in the end on the wrong side.





Attach the red yarn to the last stitch, where did sl st.

27. FLO (inc, 6 sc)*6 times (48)

28. (inc, 7 sc)*6 times (54)

29. ch2, 1 sl st, 1 sl st - repeat until the end of round

Cut the yarn, weave in the end on the wrong side.



Tuck the upper part of the candle holder inside the lower part of the candle holder.

To connect the part together, you can glue (or sew) the sides with hot glue from the wrong side (not necessary).



Attach the white yarn to the front loop of row 18 (top of the candle holder) (hold the candle holder with the bottom down).

1. Ch2

2. 1 sl st into the next loop

Repeat steps 1-2 until the end of round



- Make ch1, grab to the front loop of row 17 (next round of front loops)
1. Ch2
 2. 1 sl st into the next loop
- Repeat steps 1-2 until the end of round

Cut the yarn, weave in the end on the wrong side.



Buckle

Crochet with yellow yarn (No. 35)

Work in rows. Make ch1 at the end of each row and turn.

1. ch6, from the second chain on the hook 5 sc
- 2-3. 5 sc (2 rows)

Work around the buckle for rows 4

4. ch1, inc, 2 sc, inc, 3 sc, inc, 2 sc, inc, 3 sc, sl st

Cut the yarn and weave in the end on the back side.

Embroider the center of the buckle with a black yarn (see photos).

Glue the buckle with hot glue (or sew) to the belt of the candle holder.

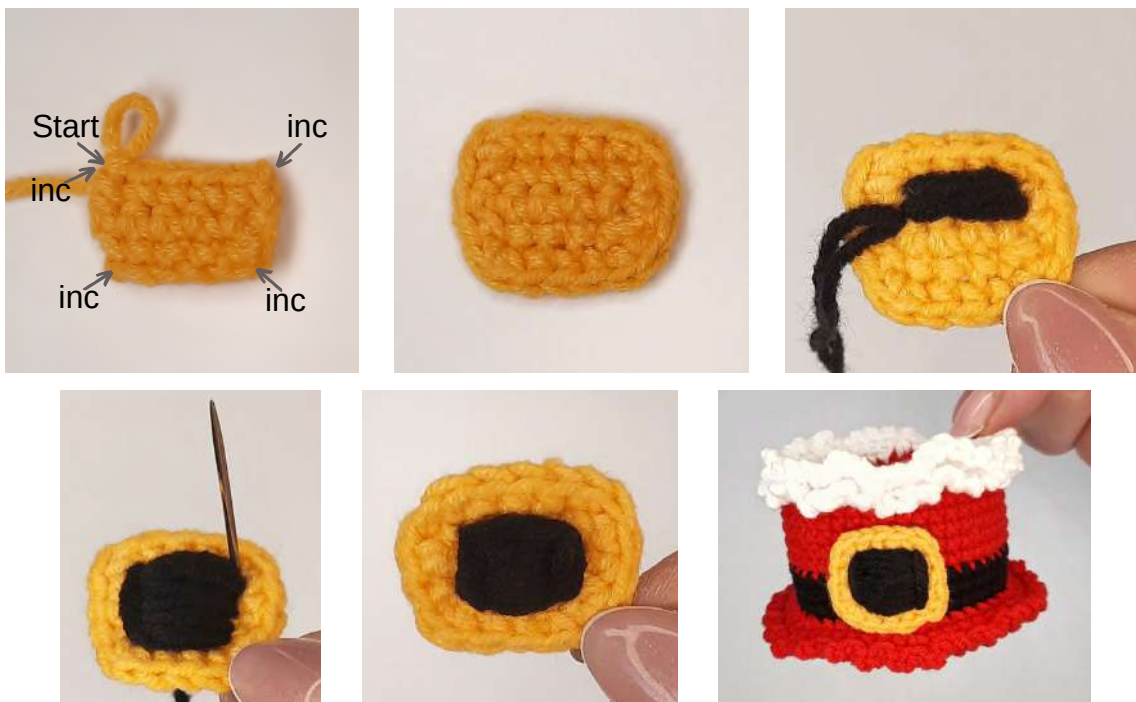



Candy candle holder



Use white yarn (No. 01)

1. 8 sc in MR
 2. inc*8 times (16)
 3. (inc, 1 sc)*8 times (24)
 4. (inc, 2 sc)*8 times (32)
 5. (inc, 3 sc)*8 times (40)
 6. BLO 40 sc
 - 7-15. 40 sc (9 rounds)
 16. BLO (inc, 19 sc)*2 times (42)
 17. BLO 42 sc
 18. 42 sc
- Sl st to the next stitch



Cut the white yarn, weave in the end on the wrong side.

Attach the red yarn (No. 90) to the last stitch, where did sl st.

- 19-21. 42 sc (3 rounds)



Cut the red yarn, weave in the end on the wrong side.

Attach the white yarn to the last stitch, where did sl st.

- 22-24. 42 sc (3 rounds)

Cut the white yarn, weave in the end on the wrong side.

Attach the red yarn to the last stitch, where did sl st.



- 25-26. 42 sc (2 rounds)

27. FLO (inc, 6 sc)*6 times (48)

Cut the red yarn, weave in the end on the wrong side.





Attach the white yarn to the last stitch, where did sl st.

28. (inc, 7 sc)*6 times (54)

29. ch2, 1 sl st, 1 sl st - repeat until the end of round

Cut the yarn, weave in the end on the wrong side.



Tuck the upper part of the candle holder inside the lower part of the candle holder.

To connect the part together, you can glue (or sew) the sides with hot glue from the wrong side (not necessary).

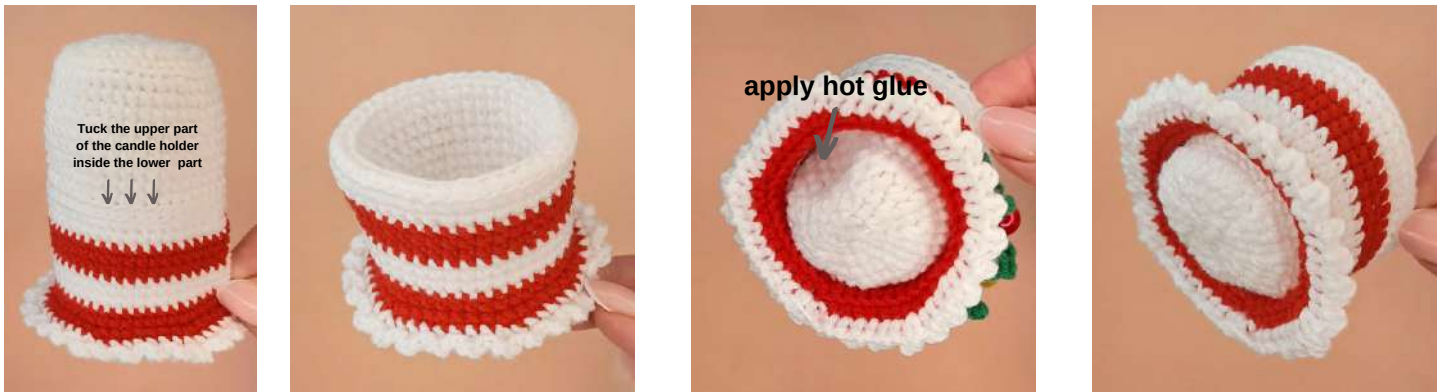

Decoration

Crochet with green yarn.

Make MR.

1. ch5, from the second chain on the hook: 1 sl st, 1 sc, 2 dc

2. 1 sl st in MR

Repeat steps 1-2 until you have 5 petals. Pull the ring.

Cut the yarn and weave in the end on the wrong side.

Sew a bead into the center (see photos).

Glue the decoration with hot glue (or sew) to the candle holder.

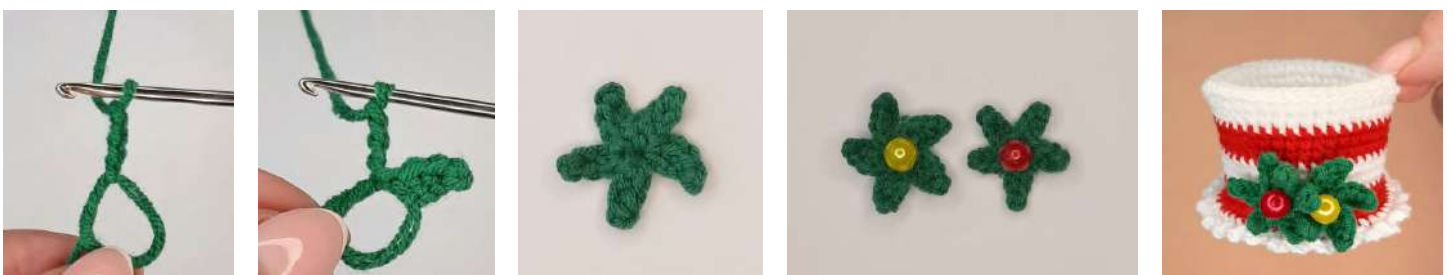



Blue candle holder

Use white yarn (No. 01)

1. 8 sc in MR
2. inc*8 times (16)
3. (inc, 1 sc)*8 times (24)
4. (inc, 2 sc)*8 times (32)
5. (inc, 3 sc)*8 times (40)
6. BLO 40 sc
- 7-15. 40 sc (9 rounds)
16. BLO (inc, 19 sc)*2 times (42)
17. BLO 42 sc

Sl st to the next stitch

Cut the white yarn, weave in the end on the wrong side.

Attach the blue yarn (No. 76) to the last stitch, where did sl st.

- 18-26. 42 sc (9 rounds)
27. FLO (inc, 6 sc)*6 times (48)
28. (inc, 7 sc)*6 times (54)

Cut the blue yarn, weave in the end on the wrong side.

Attach the white yarn to the last stitch, where did sl st.

29. ch2, 1 sl st, 1 sl st - repeat until the end of round

Cut the yarn, weave in the end on the wrong side.





Tuck the upper part of the candle holder inside the lower part of the candle holder.

To connect the part together, you can glue (or sew) the sides with hot glue from the wrong side (not necessary).



Attach the white yarn to the front loop of row 17 (see photo) (hold the candle holder upside down).

1. Ch2
 2. 1 sl st into the next loop
 3. 1 sl st into the next loop
- Repeat steps 1-3 until the end of round

Cut the yarn, weave in the end on the wrong side.

You can sew (or glue) sequins or beads to the candle holder for decoration.

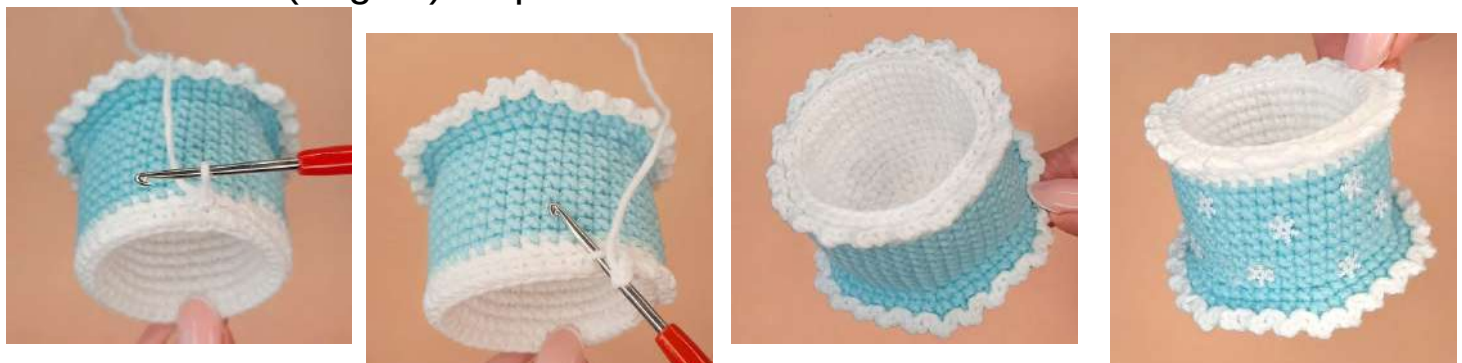



Snowman candle holder

Use black yarn (No. 53)

1. 8 sc in MR
2. inc*8 times (16)
3. (inc, 1 sc)*8 times (24)
4. (inc, 2 sc)*8 times (32)
5. (inc, 3 sc)*8 times (40)
6. BLO 40 sc
- 7-15. 40 sc (9 rounds)
16. BLO (inc, 19 sc)*2 times (42)
17. BLO 42 sc
- 18-23. 42 sc (6 rounds)

Change color to red (No. 90).

- 24-26. 42 sc (3 rounds)

Cut the red yarn, weave in the end on the wrong side.





Attach the black yarn to the last stitch, where did sl st.

27. FLO (inc, 6 sc)*6 times (48)

28. (inc, 7 sc)*6 times (54)

29. ch2, 1 sl st, 1 sl st - repeat until the end of round

Cut the yarn, weave in the end on the wrong side.



Tuck the upper part of the candle holder inside the lower part of the candle holder.

To connect the part together, you can glue (or sew) the sides with hot glue from the wrong side (not necessary).

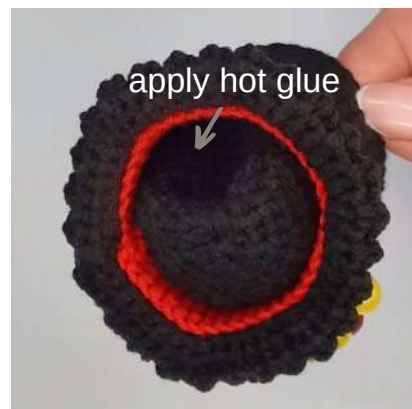



Decoration

Crochet with green yarn.

Make MR.

1. ch5, from the second chain on the hook: 1 sl st, 1 sc, 2 dc
2. 1 sl st in MR

Repeat steps 1-2 until you have 3 petals.

Pull the ring.

Cut the yarn and weave in the end on the wrong side.

Sew three beads into the center (see photos).



Glue the decoration with hot glue (or sew) to the candle holder (see photo).





Elf candle holder

Use green yarn (No. 52)

1. 8 sc in MR
2. inc*8 times (16)
3. (inc, 1 sc)*8 times (24)
4. (inc, 2 sc)*8 times (32)
5. (inc, 3 sc)*8 times (40)
6. BLO 40 sc
- 7-14. 40 sc (8 rounds)

Sl st to the next stitch

Cut the green yarn, weave in the end on the wrong side.

Attach the red yarn (No. 90) to the last stitch, where did sl st.

15. 40 sc
16. BLO (inc, 19 sc)*2 times (42)
17. BLO 42 sc

Sl st to the next stitch

Cut the red yarn, weave in the end on the wrong side.

Attach the green yarn to the last stitch, where did sl st.

- 18-24. 42 sc (7 rounds)

Cut the green yarn, weave in the end on the wrong side.

Attach the red yarn to the last stitch, where did sl st.

25. 42 sc
26. BLO 42 sc

Cut the red yarn, weave in the end on the wrong side.





Attach the green yarn to the last stitch, where did sl st.

27. FLO (inc, 6 sc)*6 times (48)

28. (inc, 7 sc)*6 times (54)

29. ch2, 1 sl st, 1 sl st - repeat until the end of round

Cut the yarn, weave in the end on the wrong side.



Tuck the upper part of the candle holder inside the lower part of the candle holder.

To connect the part together, you can glue (or sew) the sides with hot glue from the wrong side (not necessary).





Attach the red yarn to the front loop of row 17 (see photo)
(hold the candle holder upside down).

1. Ch2
 2. 1 sl st into the next loop
 3. 1 sl st into the next loop
- Repeat steps 1-3 until the end of round

Cut the yarn, weave in the end on the wrong side.



Attach the red yarn to the front loop of row 26 (see photo)
(hold the candle holder with the bottom down).

1. 1 sc
2. 1 dc into the next loop
3. 1 tr into the next loop, ch2 and 1 sl st into the top of this stitch
4. 1 dc into the next loop
5. 1 sc into the next loop
6. 1 sl st into the next loop

Repeat steps 1-6 more 6 times

So that the triangles does not stick out, sew it with a few stitches
to the candle holder.

Sew (or glue) the beads to the vertices of the triangles (see photo).





Yellow candle holder

Use yellow yarn (No. 35)

1. 8 sc in MR
2. inc*8 times (16)
3. (inc, 1 sc)*8 times (24)
4. (inc, 2 sc)*8 times (32)
5. (inc, 3 sc)*8 times (40)
6. BLO 40 sc
- 7-14. 40 sc (8 rounds)

Sl st to the next stitch

Cut the yellow yarn, weave in the end on the wrong side.

Attach the white yarn (No. 01) to the last stitch, where did sl st.

15. 40 sc
16. BLO (inc, 19 sc)*2 times (42)
17. BLO 42 sc

Change color to yellow.

18. BLO 42 sc
- 19-23. 42 sc (5 rounds)

Change color to red (No. 90).

- 24-26. 42 sc (3 rounds)

Cut the red yarn, weave in the end on the wrong side.





Attach the yellow yarn to the last stitch, where did sl st.

27. FLO (inc, 6 sc)*6 times (48)

28. (inc, 7 sc)*6 times (54)

29. ch2, 1 sl st, 1 sl st - repeat until the end of round

Cut the yarn, weave in the end on the wrong side.



Tuck the upper part of the candle holder inside the lower part of the candle holder.

To connect the part together, you can glue (or sew) the sides with hot glue from the wrong side (not necessary).

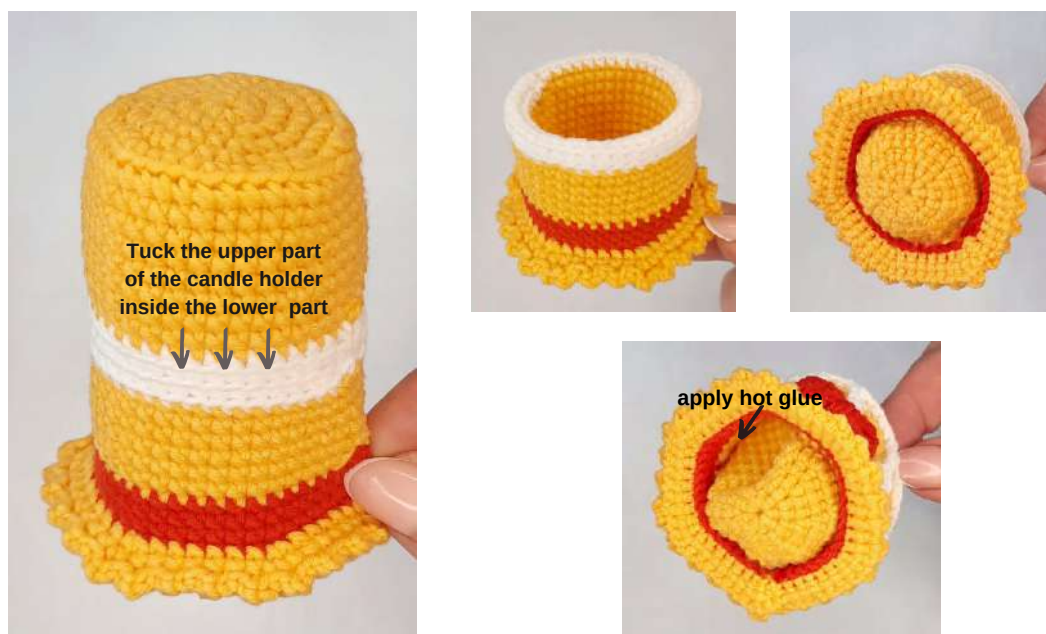



Smudges

Attach the white yarn to the front loop of row 18 (top of the candle holder)
(hold the candle holder upside down).

1. ch6, in 2rd chain crochet 3 sc in one loop, 4 sl st
2. crochet 5 sl st on the candle holder
3. ch4, in 2rd chain crochet 3 sc in one loop, 2 sc
4. skip 1 loop on the candle holder, 3 sl st on the candle holder
5. ch8, in 2rd chain crochet 3 sc in one loop, 6 sl st
6. crochet 5 sl st on the candle holder

Repeat steps 1-6 until the end of round

So that the smudges does not stick out, sew (or glue) it with a few stitches to the candle holder.





Bow

Crochet in red color.

1. start in MR: ch3
2. 4 tr
3. ch3, 1 sl st in MR
4. ch3
5. 4 tr
6. ch3, 1 sl st in MR

Pull the ring and wind it in the center with yarn tail, forming a bow.
Fasten off and cut the yarn, leaving a tail for sewing.

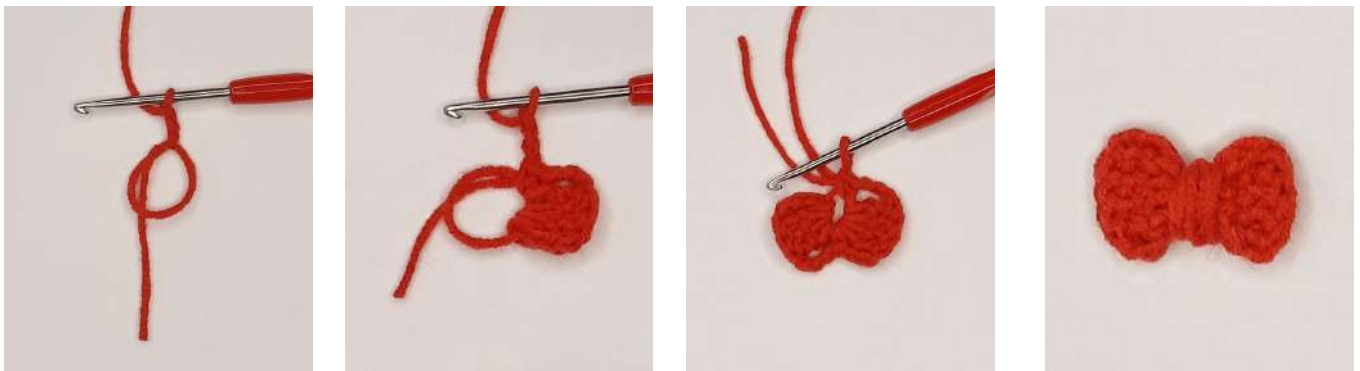

Glue the bow with hot glue (or sew)
to the candle holder.

